



TIIME

TRUST AND
INTERNET IDENTITY MEETING
EUROPE

2026, Amsterdam

THANK YOU TO OUR SPONSORS



THANKS TO ALL MY CO-ORGANISERS



Welcome to Nikhef the Dutch National Institute for Sub-atomic Physics

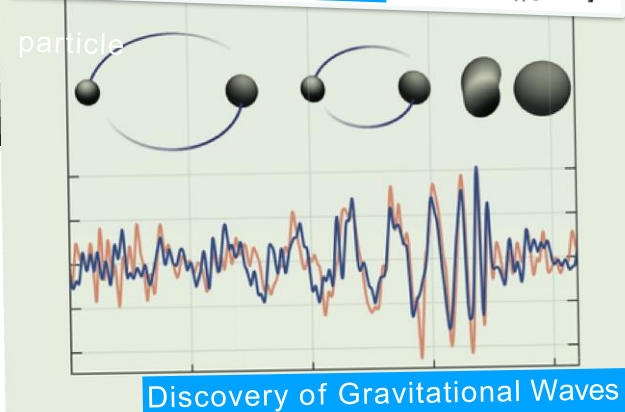
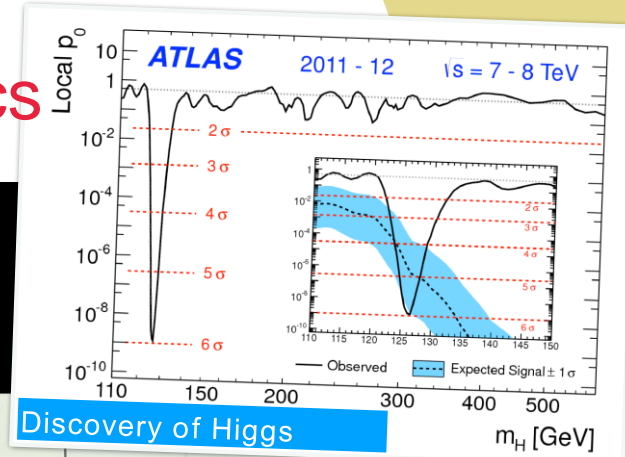
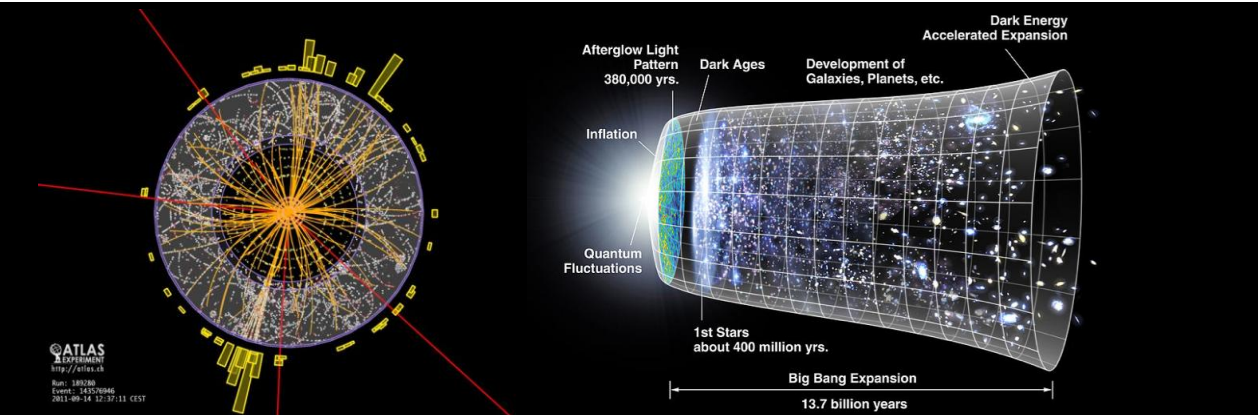

We probe our world, made of particles and fields,

- with collider physics, primarily at CERN
- astroparticle physics:
particles, radiation, and ripples coming from the universe

The Nikhef Partnership

In itself a collaborative ecosystem



Nikhef, its science and ICT programme, and the NikhefHousing data center



Nikhef

Nikhef at CERN – LHCb, Atlas, Alice

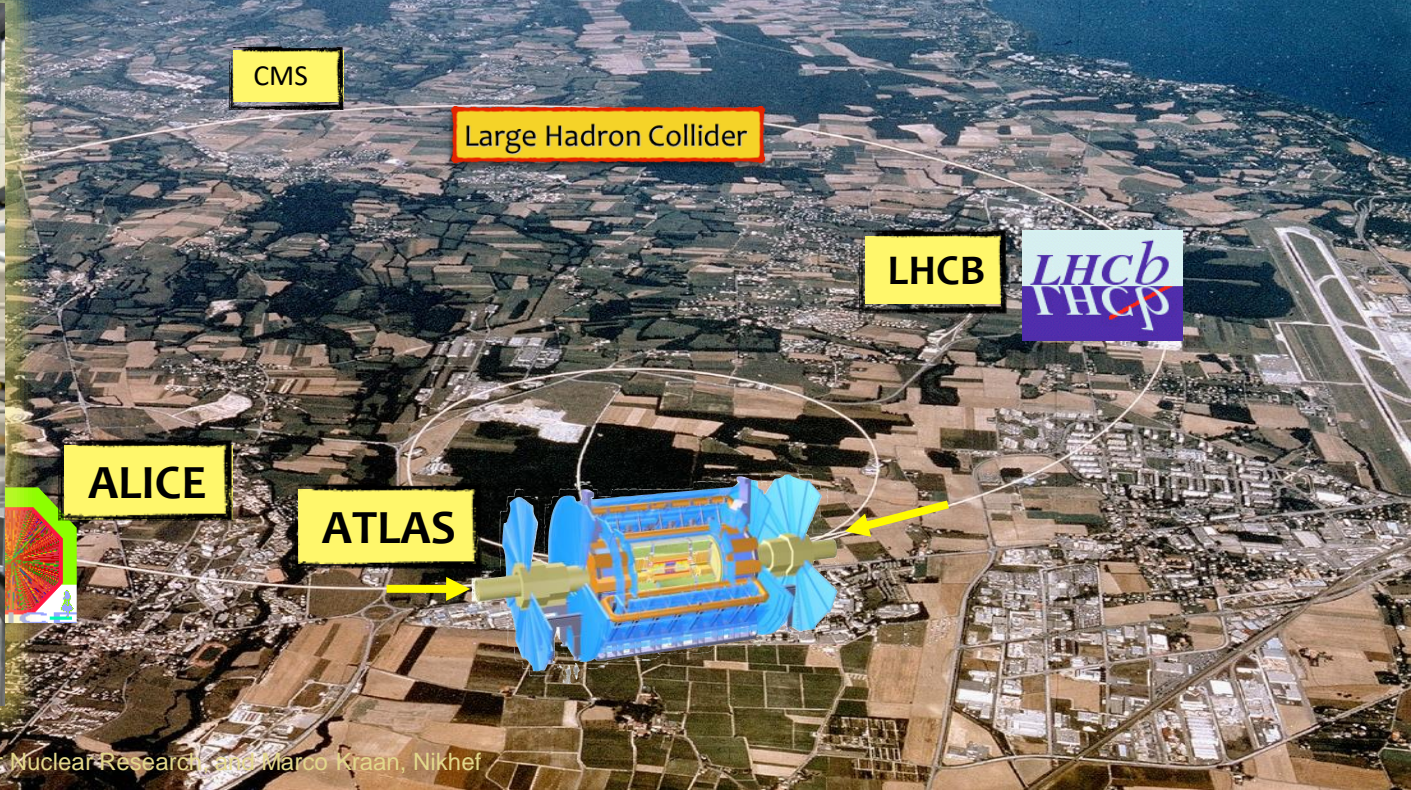

Imagery: CERN, European Organisation for Nuclear Research, and Marco Kraan, Nikhef

And decelerate for ultra-high-precision measurements

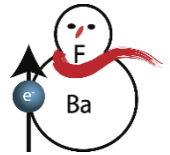
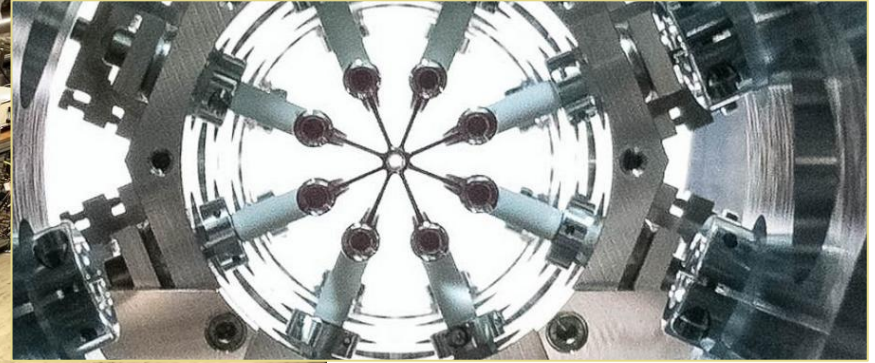
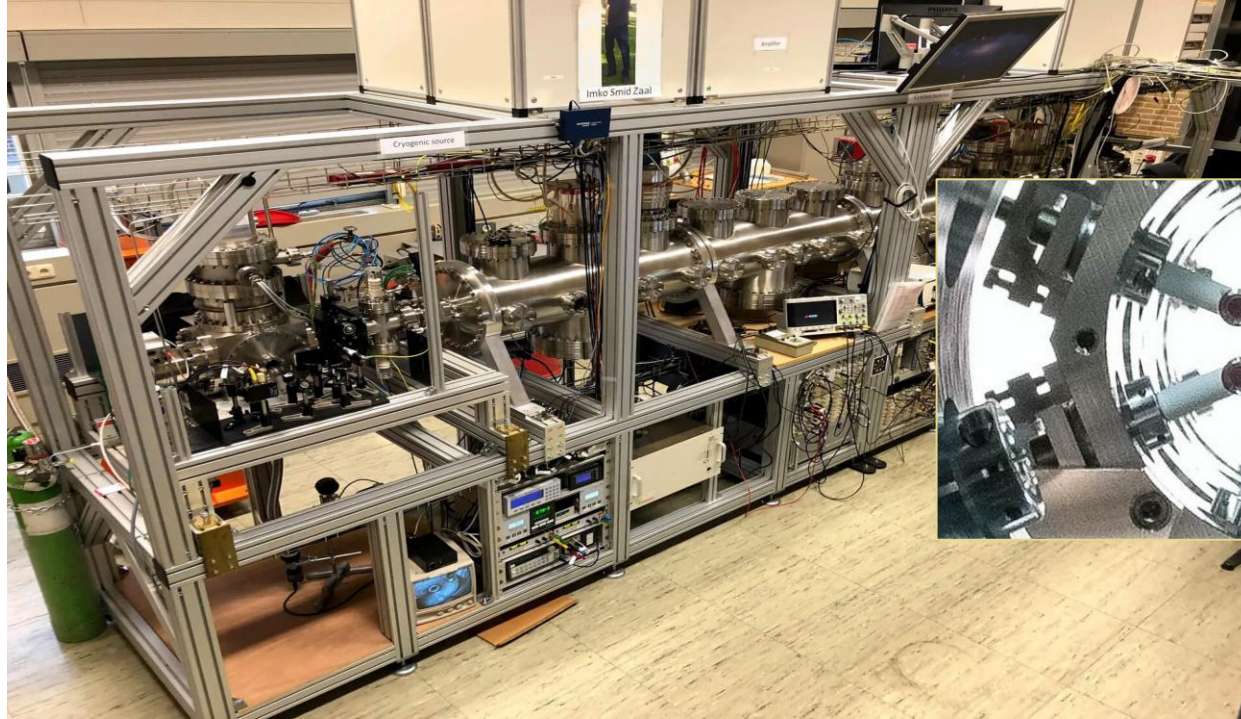

<https://www.eedm.nl/> Nikhef and Rijksuniversiteit Groningen, images: Steven Hoekstra

The astro-particle physics programmes Nikhef

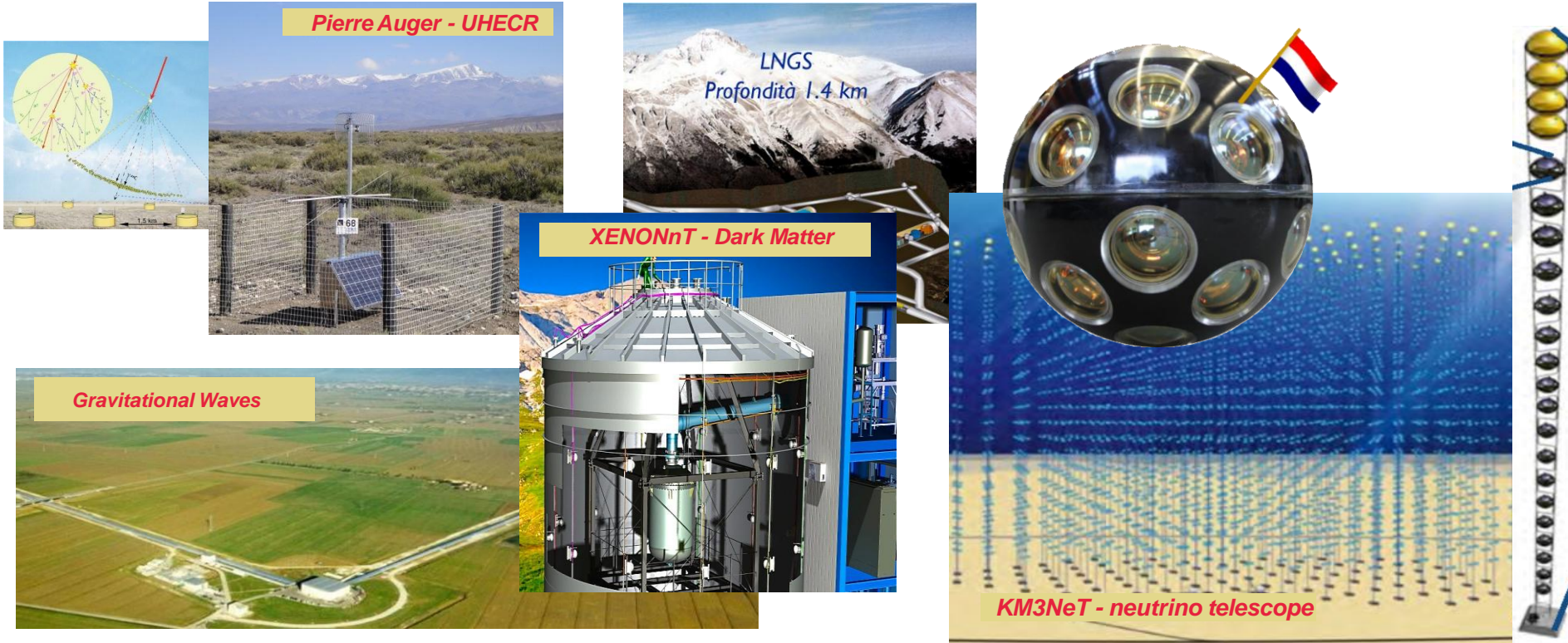

Slide: Stan Bentvelsen, Nikhef SEP 2023, KM3NeT collaboration, Virgo Collaboration, Xenon-nT collaboration, Pierre-Augur collaboration

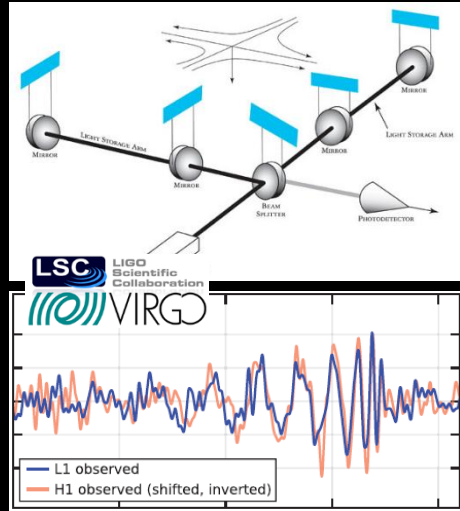

Einstein Telescope projected in the **Euregio Maas Rijn**,
images: Marco Kraan;
ET Pathfinder at UM, Maastricht, NL

GW150914 event:
gw-astronomy collaborations, LIGO

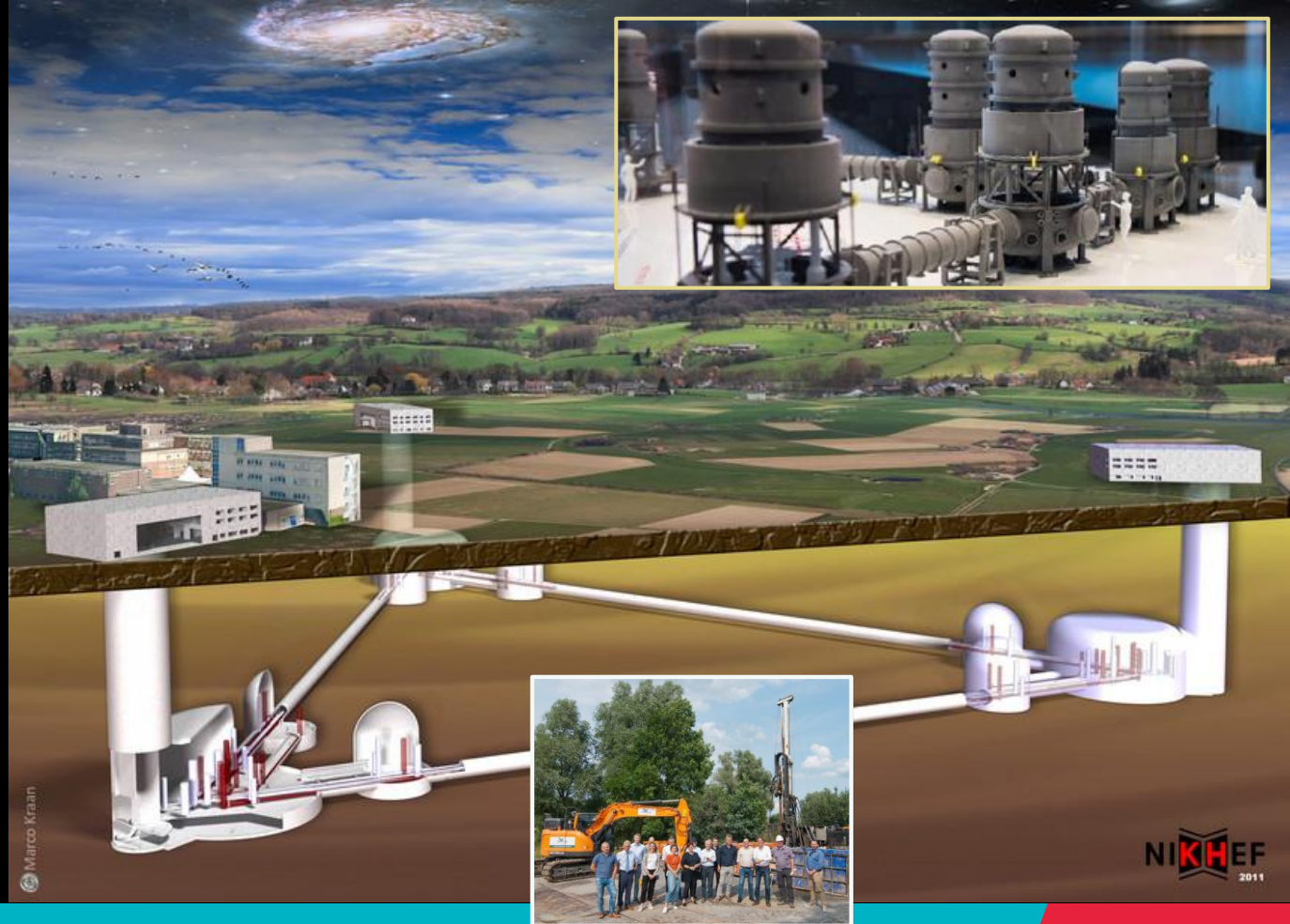

Enabling Research Programmes – next gen infrastructure



Detector R&D

Theoretical
Physics

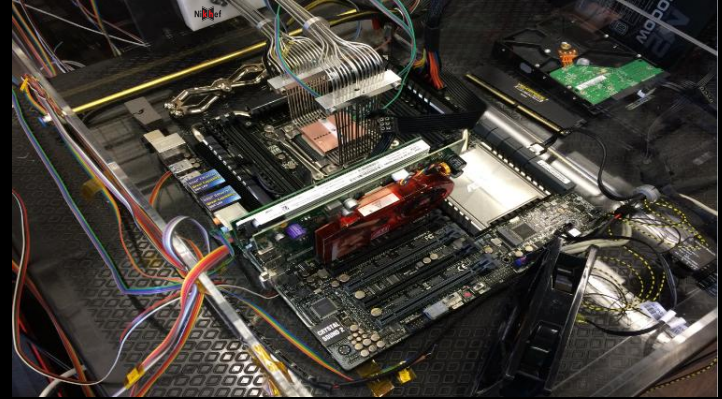

Physics Data Processing

Technical Engineering and technology transfer

'The research at Nikhef relies on the development of innovative technologies. The knowledge and technology transfer to third parties, i.e., industry, civil society and general public, is an integral part of Nikhef's mission.'



pictures from Nikhef's 'Dimensions' magazine and Computing Office Hours; <https://www.nikhef.nl/en/nikhef-mission/>

'IBR-LAN' at Nikhef – connecting local and global networks



International Backbone Router Local Area Network "IBR-LAN" at Nikhef, room H1.40 as seen in 1996. Right: H1.39 with nikhefh.nikhef.nl racks and early DAS-2 system

Connect each other ... and scientific data and instruments



What happens inside a data centre ...



‘Connectivity’ and ‘hosting’

- NikhefHousing (H140) has connectivity parties (*network*)

2nd floor has our science data centre

ROUTING YOU

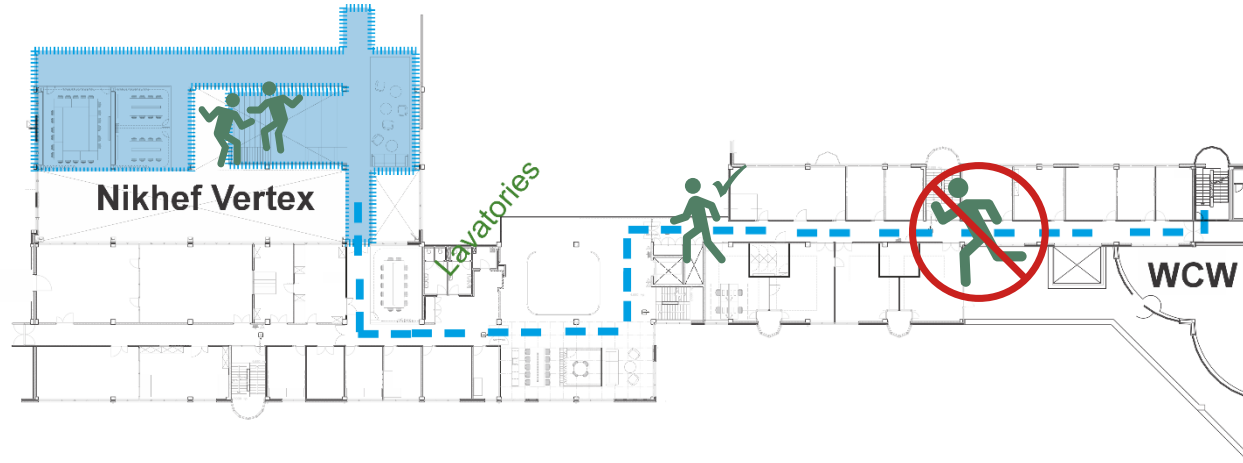

From WCW to Nikhef Vertex, indoors via stairs:
1st floor (corridor level) Positron and Electron
ground floor down stairs Colloquium

BREAKOUT COLLOQUIUM

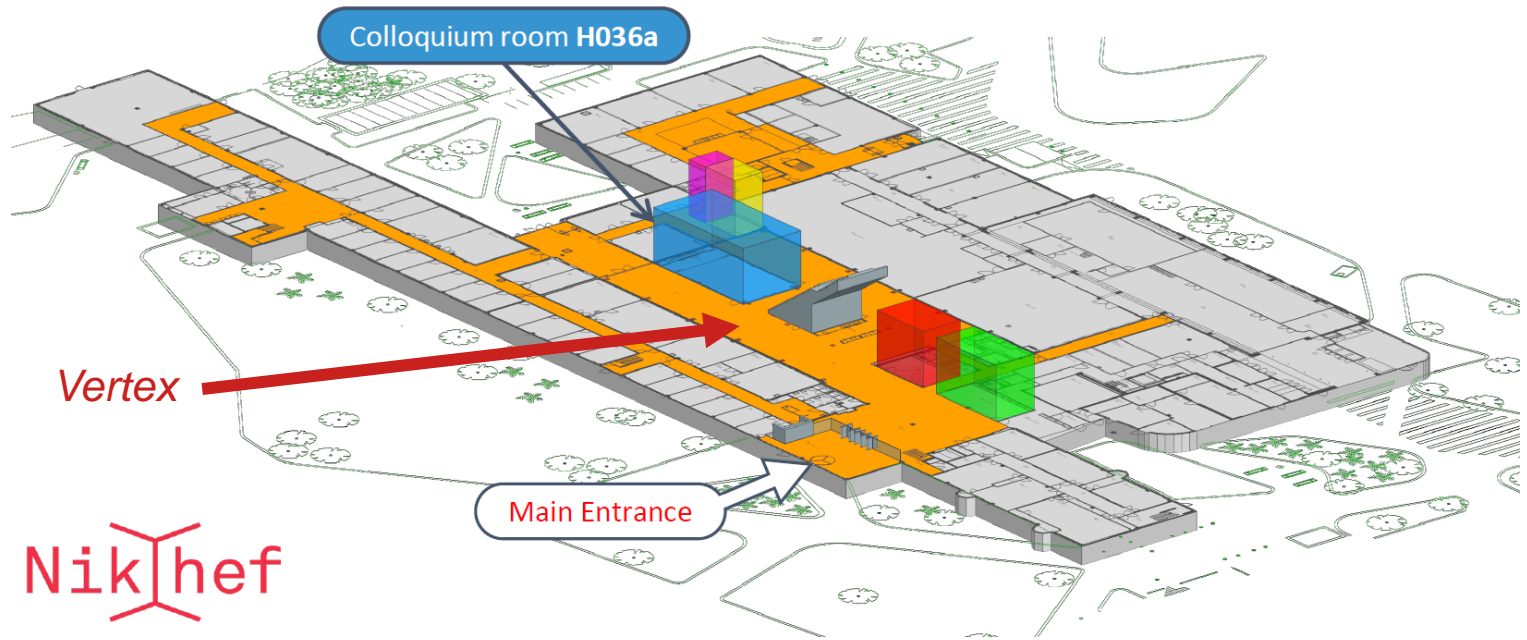

Nikhef



BREAKOUT ROOMS e^+ AND e^-

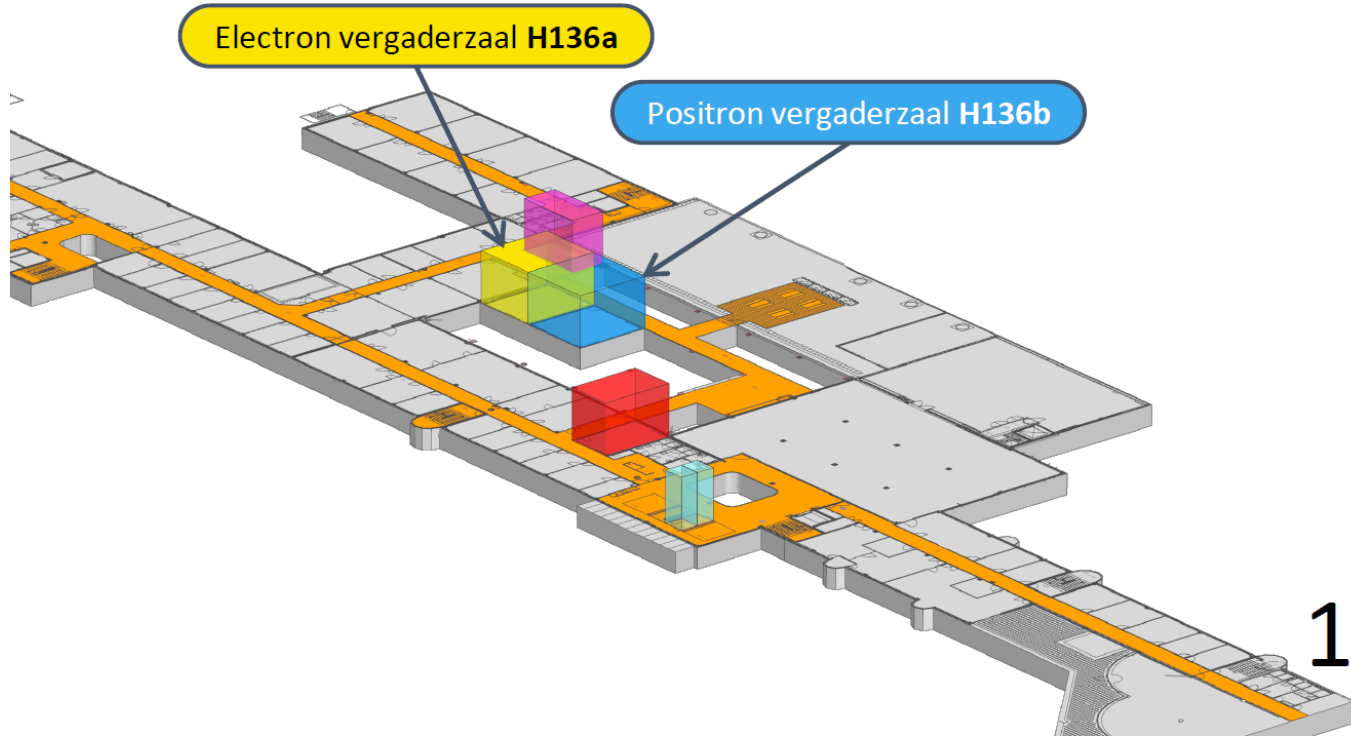

IF IT DOES NOT LOOK LIKE THIS ...



... you are in the wrong place

AND IF YOU LIKE THE WEATHER OUTSIDE





THANK YOU TO OUR SPONSORS

